

Standards:
ASTM A194-08
ASTM A370-19
ASTM A962-07
ASTM F606-16
ISO 898 - 99

Material Type:
BOLTS

Type of Testing:
TENSILE, TENSION, PROOF LOAD, CONE PROOF

FASTENER TENSILE GRIPS FOR BOLTS FROM 1" TO 1.5" DIAMETER (300 KIP)

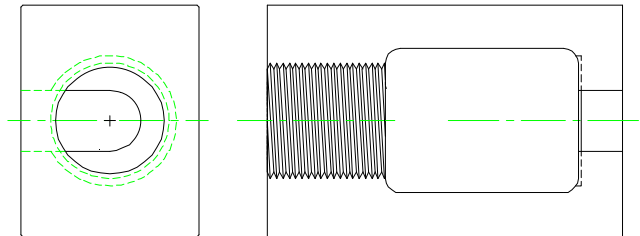

Model No.

ASTM.A0194.40
ASTM.A0370.54
ASTM.F0606.40
ISOS.00898.40

Specimen Size or Difference Between Fixtures

1" to 1.5" (M20 to M36) bolts
1" to 1.5" (M20 to M36) bolts
1" to 1.5" (M20 to M36) bolts
1" to 1.5" (M20 to M36) bolts

Construction

High strength steel
High strength steel
High strength steel
High strength steel

Temperature

-120 to 250°F (-85 to 122°C)
-120 to 250°F (-85 to 122°C)
-120 to 250°F (-85 to 122°C)
-120 to 250°F (-85 to 122°C)

Fixture:	Mounting	2.5"-12 threaded couplings
	Capacity	300,000 lbs (1334 kN)
	Weight	100 lbs approximately
	Dimensions	Assembled 6" X 5.5" X 20"
	Standard	Manufactured and sold in compliance with ASTM A194, A370, A962, F606 and ISO 898

QUOTE

Model No. ASTM.F0606.40 - Fastener Tensile Grips for Bolts From 1" - 1.5" or M25 - M38 Dia. (300 Kip)

Supplied with 2.5"-12 threaded couplings to mount to your test machine. Constructed of high strength steel with a protective black oxide finish. Manufactured in compliance with ASTM A194, A370, A962, F606 and ISO 898. Washers sold separately.

ACCESSORIES

Model No. ACC.F0606.4003 - Plain Wedge Washer (6°) (ea) from M4 to M12 or #6 to 1/2"

Model No. ACC.F0606.4004 - Plain Wedge Washer (4°) (ea) from M4 to M12 or #6 to 1/2"

Model No. ACC.F0606.4005 - Threaded Flat Washer (ea) from M4 to M12 or #6 to 1/2"

Model No. ACC.F0606.4006 - Threaded Wedge Washer (6°) (ea) from M4 to M12 or #6 to 1/2"

Model No. ACC.F0606.4007 - Top Hat Style Short Bolt Adapter (ea)

Model No. ACC.F0606.4008 - Tensile Nut Proof Load Test Fixture

Includes a mandrel for a specific class 3A thread size, corresponding hardened loading washer, and retaining nut. Constructed of high strength steel with a protective black oxide finish in accordance with ASTM F606.

Model No. ACC.F0606.4009 - Compression Nut Proof Load Test Fixture

Model No. ACC.F0606.4010 - Set of (2) Tensile Proof Load Testing Nuts

SPARE PARTS

Please contact us for spare or replacement parts

COMMON SIZE ADAPTERS

Upper and Lower Mounting: 2.5" -12 Threaded Coupling

Model No. M03S72 - 1.25" Male Clevis to 2.5"-12 Threaded Stud

Model No. S72S42 - 2.5"-12 to 1.25"-12 Threaded Step Stud

Model No. S72S48 - 2.5"-12 to 1.5"-12 Threaded Step Stud

Model No. S72S60 - 2.5"-12 to 2"-12 Threaded Step Stud

Model No. S251206 - 2.5"-12 x 6" Fatigue Rated Stud

Model No. LN72 - 2.5"-12 Threaded Locking Nut with Knurled OD

EXTRA PHOTOS:



Tensile Nut Proof Load Test Fixture



Plain Wedge Washer



Short Bolt Adapter