

Standards:
 ASTM D5045 - 07
 ASTM E399 - 17
 ASTM E647 - 15
 ASTM E1820 - 18

Material Type:
 METAL

Type of Testing:
 TENSILE, CLEVIS, FRACTURE

COMPACT TENSION LOADING CLEVIS SET - 3 MATERIALS AVAILABLE

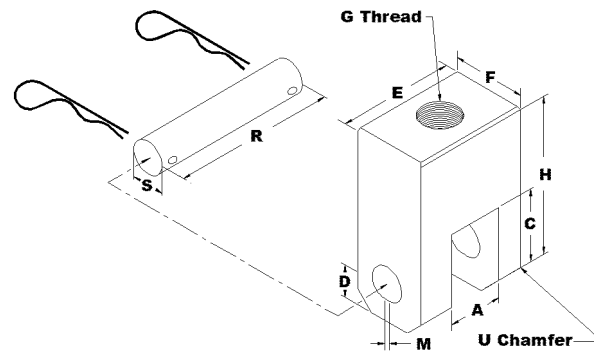

<u>Model No.</u>	<u>Specimen Size or Difference Between Fixtures</u>	<u>Construction</u>	<u>Temperature</u>
ASTM.D5045.XX	D-shape pin hole	3 Material Options Available:	
ASTM.E0399.XX	D-shape pin hole	17-4 PH	-240 to 600°F (-152 to 318°C)
ASTM.E0647.XX	D-shape pin hole	Maraging 300	-240 to 600°F (-152 to 318°C)
ASTM.E1820.XX	Square, Round or D-shape pin hole	Inconel 718	Up to 1800°F

Specimen: Width 0.4" to 4"
 Length Any
 Thickness 0.4" - 8"

Fixture: Mounting Threaded couplings - see chart
 Dimensions See chart
 Standard Manufactured in compliance with ASTM D5045, E399, E647 and E1820

Model No.	Material Selection			Specimen Size		Compact Tension Clevis Dimensions						
	Material Code			(B)	(W)	(A)	(H)	(C)	(E)	(F)	(G)	(S)
	Stainless 17-4PH	Inconel 718	Mar-M 300	Thickness	Length	Slot	Height	Slot Depth	Width	Depth	Thread	Pin Diameter
ASTM.E0399	.01	.21	.41	0.40"	0.8"	0.412	2	0.608	1.25	1.25	3/4"-10	0.192
ASTM.E0399	.02	.22	.42	0.5"	1"	0.515	2	0.76	1.25	1.25	3/4"-10	0.240
ASTM.E0399	.03	.23	.43	0.60"	1.2"	0.618	2.5	0.912	1.25	1.25	3/4"-10	0.288
ASTM.E0399	.04	.24	.44	0.75"	1.6"	0.773	2.5	1.14	1.50	1.25	3/4"-10	0.360
ASTM.E0399	.05	.25	.45	0.8"	3"	0.824	3	1.216	1.60	1.25	3/4"-10	0.384
ASTM.E0399	.06	.26	.46	1"	2"	1.030	3	1.52	2.00	1.20	3/4"-10	0.480
ASTM.E0399	.07	.27	.47	1.25"	2.5"	1.288	3.5	1.9	2.50	1.50	3/4"-10	0.600
ASTM.E0399	.08	.28	.48	1.5"	3"	1.545	4	2.28	3.00	1.80	1"-14	0.720
ASTM.E0399	.09	.29	.49	1.75"	3.5"	1.803	4.5	2.66	3.50	2.10	1"-14	0.840

ASTM.E0399	.M2501	.M2502	.M2503	25mm	50mm	25.76	76.2	38.1	50.8	50.8	M27-2	12
ASTM.E0399	.M3001	.M3002	.M3003	30mm	60mm	30.87	101.6	57	63.5	38.1	M27-2	14.35

MTT '21 rev. A, Prices subject to change without notice

QUOTE

Model No. ASTM.E0399.XX - Compact Tension Loading Clevis Set **(3 Materials Available)**

(B) Specimen Width =
(W) Specimen Length =
Loading Pin Diameter =
Clevis Thread Size =
Pin Hole Shaped = D-shape

Precision machined compact tension loading clevis set of (2) with loading pins and retaining hairpins. Each clevis is supplied with a female thread for attachment with a fatigue rated loading stud. Each clevis is constructed of **(available in 3 different materials)** and manufactured in compliance with ASTM D5045, E399, E647 and E1820.

SPARE PARTS

Model No. SPA.E0399.XX01 - Extra set of (2) (S) diameter loading pins made from XXX material

Model No.SPA.E0399.XX02 - Extra set of (4) retaining hairpin clips for ASTM.E0399.XX

ACCESSORIES

Model No.SPA.E0399.XX.XXX - Extra set of (4) Spacers for 0.118" Wide Specimen on ASTM.E0399.XX

COMMON SIZE ADAPTERS

Lower and Upper Mounting: XX Female Coupling

Model No. M03SXX - 1.25" Male Clevis to (G) Threaded Stud

Model No. S48SXX - 1.5"-12 to (G) Threaded Step Stud

Model No. S42SXX - 1.25"-12 to (G) Threaded Step Stud

Model No. S36CXXA - 1"-14 to (G) Threaded Reducer

Model No. LNXX - (G) Threaded Locking Nut with Knurled OD

EXTRA PHOTOS:

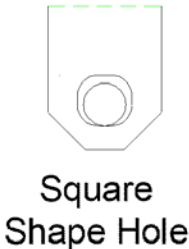
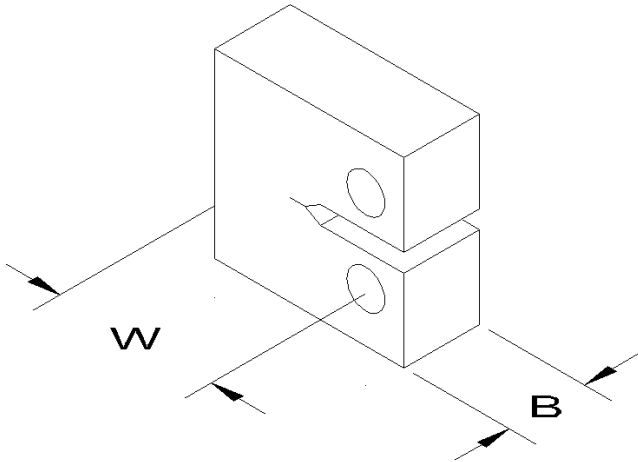

Specimen Drawing