

Standards:

ASTM A370 - 19
ASTM B557 - 02
ASTM C1273 - 18
ASTM D3552 - 17
ASTM E8 - 01

Material Type:

METAL

Type of Testing:

TENSILE

SHOULDER-END (BUTTON HEAD) SPECIMEN HOLDER COLLETS

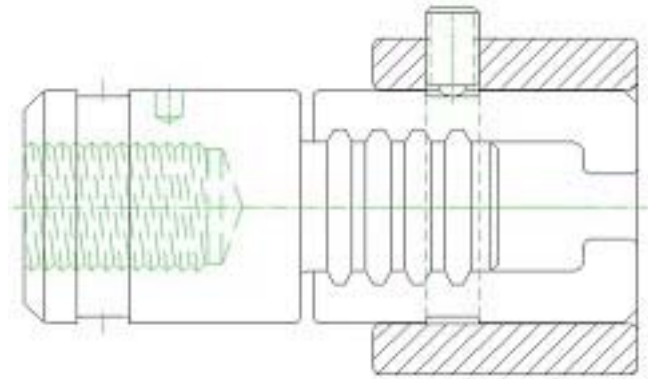

Model No.

ASTM.A0370.30
ASTM.B0557.30
ASTM.C1273.30
ASTM.D3552.30
ASTM.E0008.30
ASTM.E0021.30

Specimen Size or Difference Between Fixtures

0.505" Diameter
0.505" Diameter
0.505" Diameter
0.505" Diameter
0.505" Diameter
0.505" Diameter

Construction

High strength steel
High strength steel
High strength steel
High strength steel
High strength steel
High strength steel

Temperature

-120 to 250°F (-85 to 122°C)
-120 to 250°F (-85 to 122°C)
-120 to 250°F (-85 to 122°C)
-120 to 250°F (-85 to 122°C)
-120 to 250°F (-85 to 122°C)
-120 to 250°F (-85 to 122°C)

Fixture:	Mounting	1.5"-12 threaded coupling
	Capacity	50,000 lbs
	Weight	Approximately 20 lbs
	Dimensions	3" diameter x 12"
	Standard	Manufactured in compliance with ASTM A370, B557, C1273, D3552, E8 and E21

QUOTE

Model No. ASTM.A0370.30 - Shoulder-End (Button Head) Specimen Holder Collets

The grips consist of two sets of shoulder holder assemblies, which include: two threaded loading shafts, two retaining collars and one set of split collets for standard 0.505" specimen geometry. The fixture comes with 1.5"-12 threaded couplings and has a temperature range of -120 to 250°F (-85 to 122°C). Constructed of high strength steel with a protective finish. Manufactured in compliance with ASTM A370, B557, C1273, D3552, E8 and E21.

ACCESSORIES

Model No. ACC.A0370.3001 - 0.252" Collets (2 sets of (2) matched halves)

Model No. ACC.A0370.3002 - 0.357" Collets (2 sets of (2) matched halves)

Model No. Cert - Certificate of Compliance for ASTM.A0370.30

Model No. Cert - Certificate of Compliance for ASTM.B0557.30

Model No. Cert - Certificate of Compliance for ASTM.E0008.30

SPARE PARTS

Model No. SPA.A0370.3001 - 0.505" Replacement Collets (2 sets of (2) matched halves)

COMMON SIZE ADAPTERS

Upper and Lower Mounting: 1.5"-12 Female Coupling

Model No. M03S48 - 1.25" Male Clevis to 1.5"-12 Threaded Stud

Model No. S48S42 - 1.5"-12 to 1.25"-12 Threaded Step Stud

Model No. S151206 - 1.5"-12 x 6" Fatigue Rated Stud

Model No. S60S48 - 2"-12 to 1.5"-12 Threaded Step Stud

Model No. LN48 - 1.5"-12 Threaded Locking Nut with Knurled OD